

PD SP 800 i+

SUPERIAL 800 i+ PANEL DOORS



Thermally insulated aluminium system designed for the design of single-leaf panel doors.

PD SP 800 i+

Thermally insulated aluminium system designed for the design of single-leaf panel doors.

SP 800 i+ panel door system is a solution based on the SP 800 i+ door system; it is characterized by very good thermal insulation and new sealing solutions.

The system is compatible with the SUPERIAL system. The door leaf is adapted to the most common panel glued on both sides.

The filling panels are available in various designs and colours. The techniques for the milling of different shapes, making decorative applications and putting in glass units used in their production provide an endless number of combinations and variants.

Wide range of colours available - RAL palette, structural colours, Aliplast Wood Colour Effect, bi-colour.

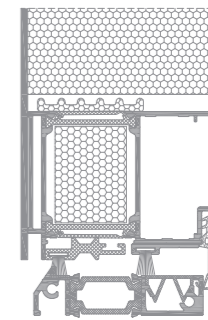

PD SP 800 i+ door section

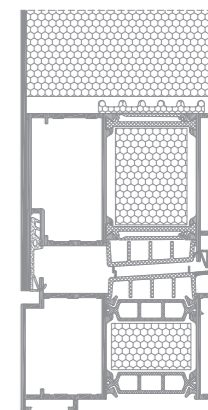

PD SP 800 i+ door section

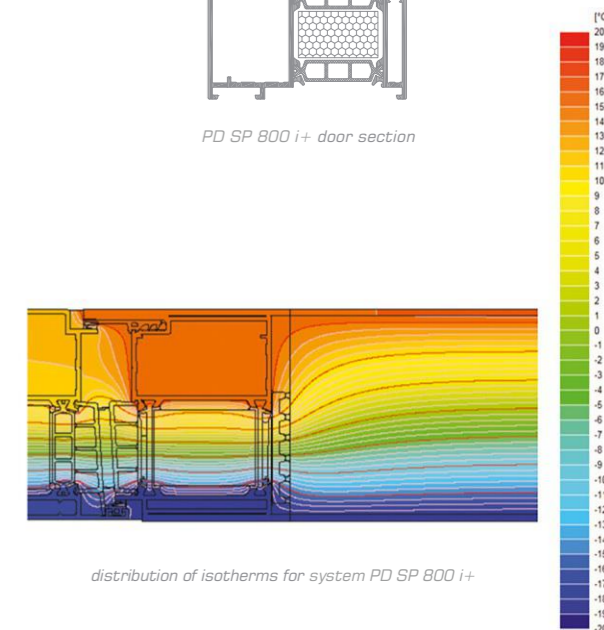

distribution of isotherms for system PD SP 800 i+

TECHNICAL SPECIFICATION

| SYSTEM | MATERIAL | DEPTH OF FRAME | DEPTH OF LEAF | GLAZING RANGE | TYPE OF WINDOWS | TYPE OF DOORS |
|--------------|----------------------|-------------------------|---------------|---------------|-----------------|---------------|
| PD SP 800 i+ | aluminium / polyamid | 75 mm / 75,5 mm / 75 mm | | | — | tilt-turn |

PERFORMANCE

| SYSTEM | THERMAL INSULATION Uf * | AIR PERMEABILITY | WINDLOAD RESISTANCE | WATERTIGHTNESS |
|--------------|---------------------------------|-------------------|------------------------|-----------------------|
| PD SP 800 i+ | Uf from 1,60 W/m ² K | Class 4; EN 12207 | C5 (2000 Pa); EN 12210 | 8A (450 Pa); EN 12208 |

* Thermal insulation is dependent on a combination of profiles and thickness of the filling.